

Vecchio
Old
Nouveau
Alt
Viejo

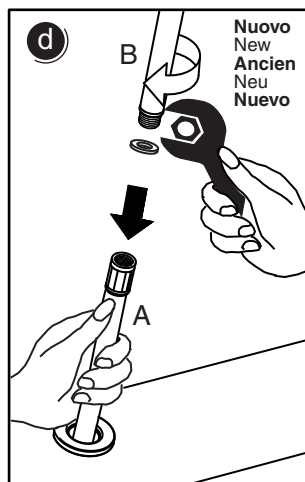

Nuovo
New
Ancien
Neu
Nuevo

Collegare perfettamente il nuovo flessibile al raccordo, con guarnizione interposta, facendo attenzione a non mollare la presa del flessibile (punto A in Fig. C), perché, un suo eventuale rientro al di sotto del bordo vasca, impedirebbe il recupero dello stesso. L'installazione deve avvenire senza dal punto di collegamento di alimentazione al punto di fuoriuscita della doccia sul bordo vasca, **NON DEVE ESSERE SUPERIORE A 70 Cm.**, in quanto **NON SAREBBE POSSIBILE** sostituire il flessibile B (cm.150).

Connect the new flexible to the connection, with the gasket in between, paying attention not to loose grip on the flexible (point A in picture C), because an incidental entry below the bath deck mixer will hamper its collection. The installation must be done without exceeding the distance between the feeding point and the way out of the hand shower on the bath deck, **MUST NOT EXCEED THE LENGTH OF (70 Cm.)** due to the fact that it will be **IMPOSSIBLE** substituting flexible B. (150 Cm.)

Connecter parfaitement le nouveau flexible au raccord avec garniture interposée, en prenant attention de ne pas lâcher la prise du flexible (point A figure C) car un éventuel escamotage sous du bord de la baignoire empêcherait de récupérer le flexible. L'installation doit être faite sans excéder la distance entre le point d'alimentation et la sortie d'eau de la douche sur le bord de la baignoire, **NE PAS ÊTRE SUPÉRIEUR A 70 Cm** car le flexible B (cm. 150) **NE POURRAIT ÊTRE CHANGÉ.**

Verbinden Sie den neuen Schlauch nach Zwischenlegen der Dichtung ganz auf das Anschlussstück aufdrehen; dabei darauf achten, den Schlauch (Punkt A auf Abb. C) gut festzuhalten, damit er unter den Wannenrand rutscht, verloren ist. Die Installation muss zwischen Anschlusspunkt der Wasserleitung und Ausgangspunkt der Handbrause auf dem Wannenrand, **MUSS NICHT 70 cm ÜBERSCHREITEN**, da es **WÄRE ES NICHT MÖGLICH**, den Schlauch B auszutauschen (cm 150).

Conectar perfectamente el nuevo flexible al tubo, con las juntas adjuntas, prestando atención de no aflojar la presa del flexible (punto A in Fig. C), porqué un eventual escamotaje debajo del borde de la bañadera, no permitiría recuperarlo. La instalación debe hacerse sin exceder la distancia del punto de conexión de alimentación al punto de agujero de salida de la ducha sobre la bañera, **NO DEBE SUPERAR LOS 70 cm.** En caso contrario **NO SERÍA POSIBLE** sustituir el flexible B.

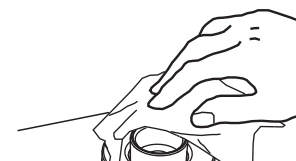
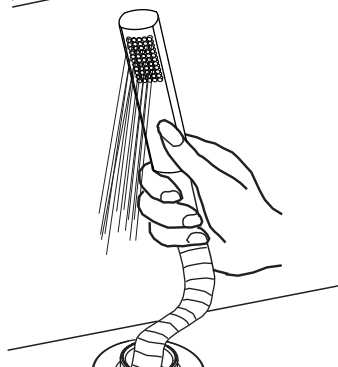
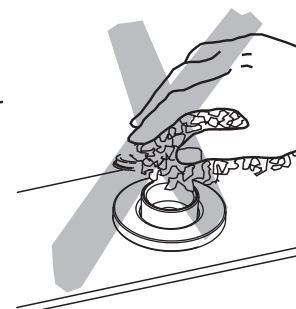
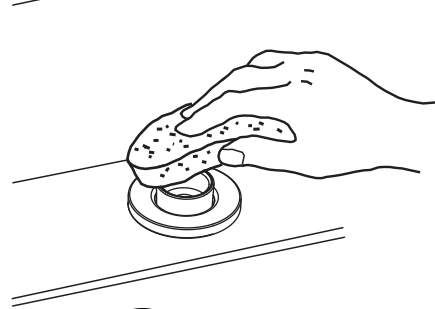
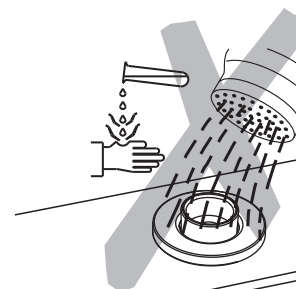
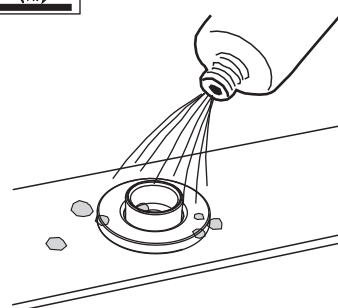
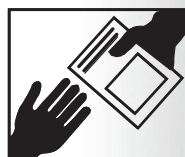
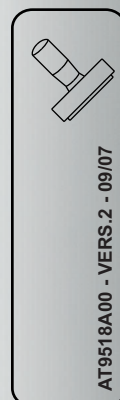

Collegamento doccia
Shower connection
Connexion à la douche
Verbindung Brause
Conexión ducha

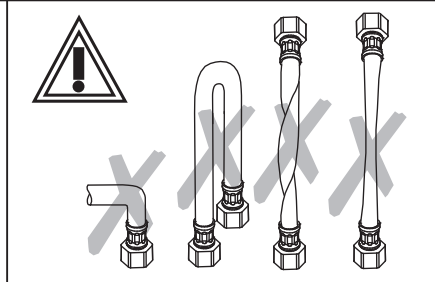
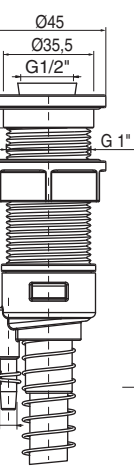

Collegamento di alimentazione
Feeding connection
Enclenchement d'alimentation
Versorgungsverbindung
Conexión de alimentación

G3/8"

Flessibile (B) - Cm. 150
Flexible Hose (B) - Cm. 150
Flexible (B) - Cm.150
Schlauch (B) - Cm.150
Flexible (B) - Cm.150

Flessibile (A) - Cm.100
Flexible Hose (A) - Cm. 100
Flexible (A) - Cm.100
Schlauch (A) - Cm.100
Flexible (A) - Cm.100

Raccordo di collegamento dei Flessibili A e B

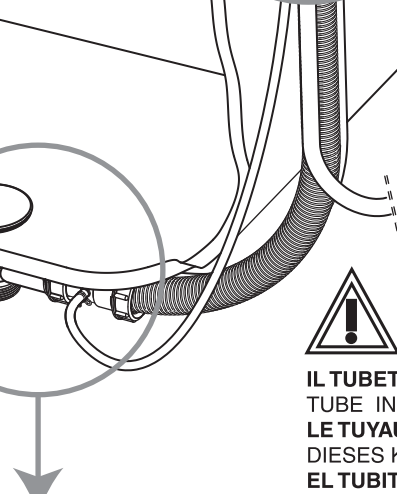

IL TUBETTO E' IN DOTAZIONE.
TUBE INCLUDED IN THE PACKAGING.
LE TUYAU EST FOURNIT.
DIESES KLEINE ROHR GEHÖRT ZUM LIEFERUMFANG.
EL TUBITO VIENE ENTREGADO EN DOTACION.

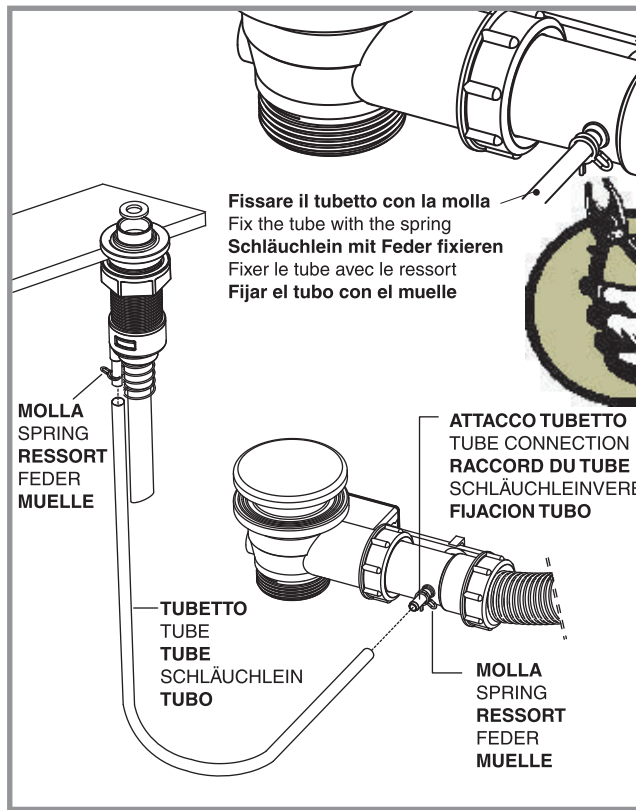
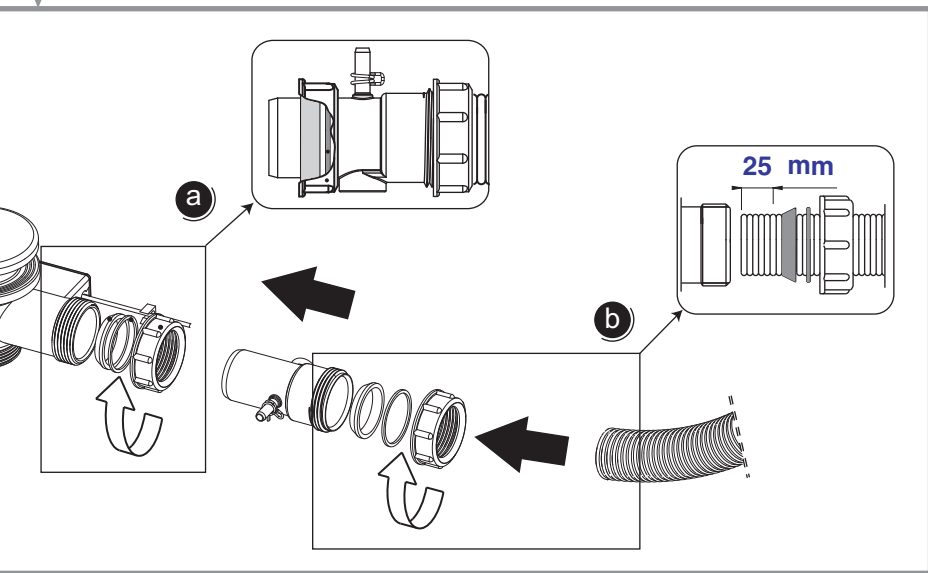
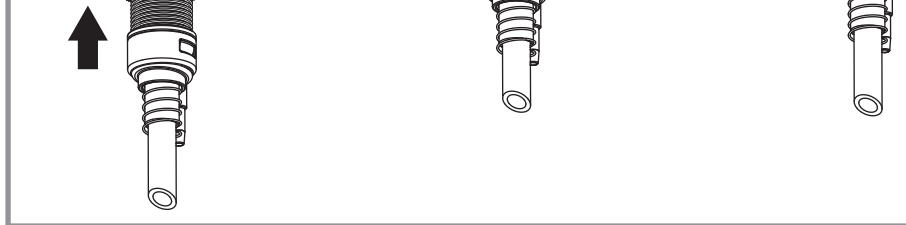

Fissare il tubetto con la molla
Fix the tube with the spring
Schläuchlein mit Feder fixieren
Fixer le tube avec le ressort
Fijar el tubo con el muelle

MOLLA
SPRING
RESSORT
FEDER
MUELLE

ATTACCO TUBETTO
TUBE CONNECTION
RACCORD DU TUBE
SCHLÄUCHLEINVERB
FIJACION TUBO

TUBETTO
TUBE
TUBE
SCHLÄUCHLEIN
TUBO

MOLLA
SPRING
RESSORT
FEDER
MUELLE

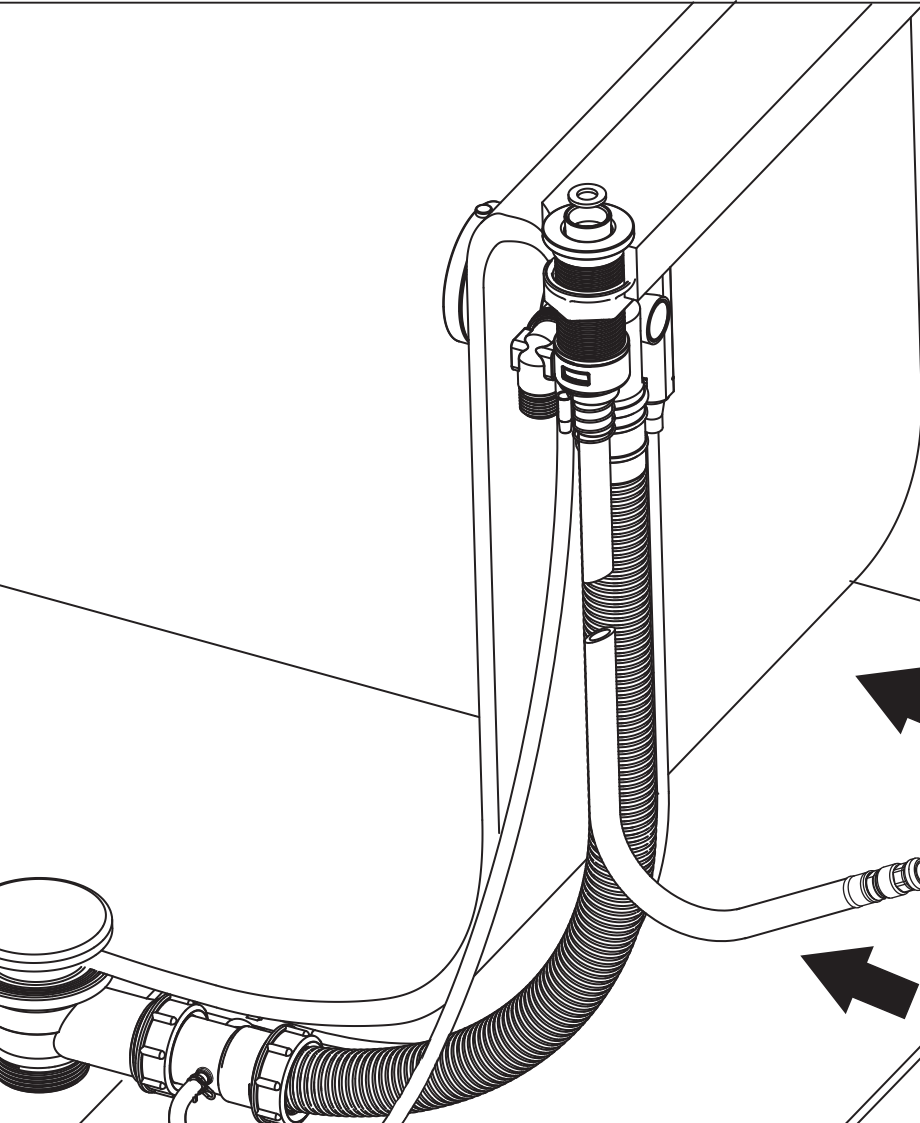

Si raccomanda di pulire perfettamente la superficie del pavimento al di sotto della vasca, per agevolare il rientro del flessibile completo di molla. Nel caso in cui il pavimento non sia rivestito da piastrelle oppure le stesse abbiano superficie ruvida, posizionare un pannello liscio così come raffigurato.

We recomend to perfectly clean the floor surface under the bathtub to facilitate flexible pipe and spring return. If the floor is not tiled or is covered with coarse tiles, please use a smooth panel as shown in the picture.

Nous recommandons de nettoyer parfaitement le sol dessous la baignoire afin de faciliter le passage du flexible avec le ressort. Si le sol n'est pas recouvert de carrelage ou que ce dernier ne soit pas lisse, positionner une plaque lisse comme sur le dessin ci-joint.

Wir empfehlen, die Bodenoberfläche unter der Dusche sehr gut zu putzen, um das Schläuchlein komplett mit